



C/- P.O. Rhyll, Victoria, 3923.

VICTORIAN RAILWAYS 10'6" WHEELBASE T VAN

Prototype Notes

The "T" van was designed for the carriage of perishable goods requiring refrigeration in summer, although other classes of goods could be carried in certain conditions. The wagon was cooled with ice and heavily insulated to remain cold for several days.

The model is based upon the 10ton wooden version first introduced in 1894. Further vans of broadly similar design were constructed in the years up to 1904 until there were 191 vans, numbered 1-191. The capacity of these vans was increased to 12 tons in 1908 and further increased to 12 ½ tons when the buffers were removed in the mid to late 1950s. Various changes were made to the vans over the years, including auto' coupled underframes, end reinforcement, Bohn door fasteners and standardised door hinges. The kit represents a wagon running from the mid 1950s onwards. The April 1995 issue of the Australian Model Railway Magazine features an article on the VR T vans which provides further information on their history.



Model illustrated has been fitted with handbrake, shunter's steps and couplers (not included).

Assembly

It is recommended that this kit be assembled with a liquid solvent such as Testor's or MEK. Each part is attached to the runner by a small 'gate'. When removing a part, cut close to the runner, then carefully trim and file the gate to the part. Leave parts on the runners until called for on the instructions, and **do not** twist them off, as they may be damaged.

To create the shorter sides for this wagon, remove the excess boards marked in Fig.1 by making a number of light cuts along the lines indicated with a single edged razor blade, hobby knife or scalpel and then 'snapping' the sides. Dress the cuts square with a file and check that the overall length of the side is 61.5mm before joining the sections together with cement. If desired, reinforce the joint by cementing a scrap of styrene to the back of the side, leaving adequate clearance for the floor.

Fig. 1

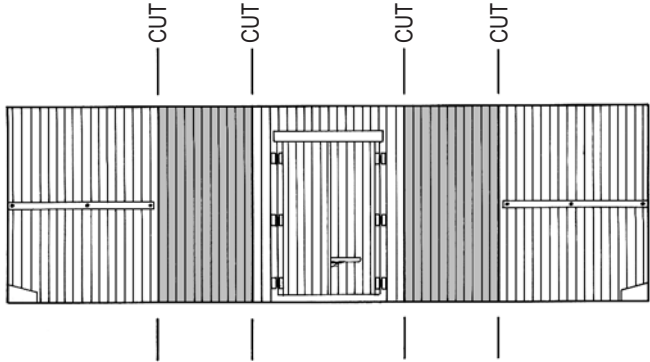

When the sides have set, assemble the sides and ends to form an open box. Ensure that the sides and ends are square to each other and set aside to harden.

Carefully remove the ice hatch seats from the roof moulding and shorten the roof to 66mm as per Fig.2. To ensure a good fit with the sides and ends the shortened end of the roof will require a rebate filed into the underneath surface at the centre. Glue to the body assembly. Glue the roof hatches and the cleat to the roof at the positions marked on Fig.2. Cut the square plastic strip into two 21mm lengths. Glue the strip to the mounting blocks on the wagon ends with one end on the drain outlet and the other end to the right of the coupler.

Fig. 2

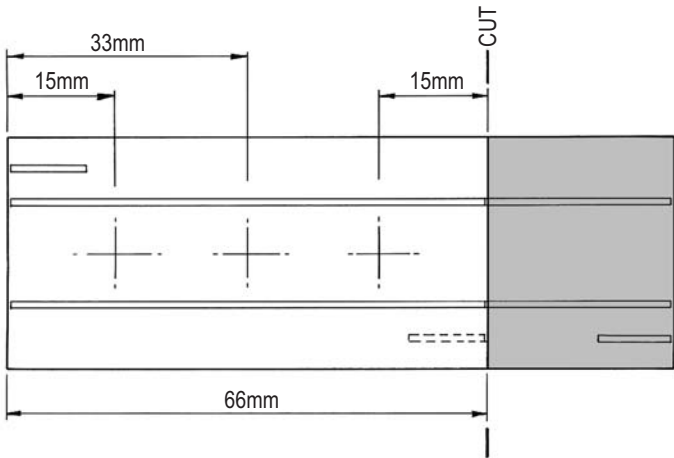

Trim the floor moulding to the cut lines indicated on Fig. 3 using a hobby knife and steel straight edge. **Check that the floor is a neat fit in the body before adding the side sills.**

Fig. 3

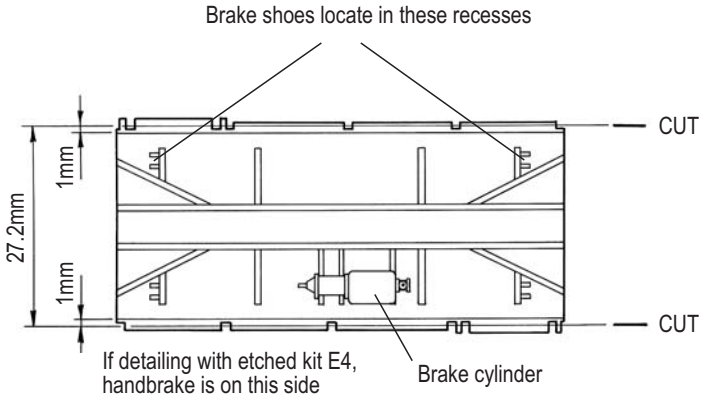

Remove the draw or slight taper from the top of each side sill by careful sanding. Glue a piece of 180 grit 'Opencote' aluminium oxide sandpaper to a flat piece of wood and rub the top edges of the side sills over it, using a second block of wood with an edge planed square as a guide. This step will ensure that the side sills are installed at 90° to the floor. Fit the acetal bearings into the holes in the axle boxes.

Cement the side sills to the floor with the wheelsets sandwiched between. Make sure that the back of each side sill is hard up against the floor structure, that the wheelsets turn freely and that the axles are at 90° to the side sills. Cement the brake cylinder to the floor in the location shown in Fig. 3. Cement the brake shoes to the floor, using the lugs moulded on the floor as a guide. Ensure that the brake shoes do not drag on the wheels.

Install the assembled underframe in the body so that the lower edges of the side sills are flush with the bottom edge of the headstocks. The underframe is designed to accept Kadee No 5 or No 58 couplers, which may be cemented directly to the floor, after first removing the side lugs from the couplers draft gear box. Etched brass shunter's steps and handbrake detail is available separately in Steam Era Models kit E4, which contains sufficient parts for five wagons.

Painting and Decals

The model should be painted VR wagon red overall, with a brown roof. We recommend Steam Era Models VR wagon red spraying enamel for the underframe and body, and Humbrol No 29 'matt dark earth' for the roof. Position the lettering as shown on the diagram.

To Apply Decals

Trim decals close to lettering to remove excess film.

Immerse in water for ten or fifteen seconds, then set aside on a tissue until the decal straightens out.

Slide the decal into position. If it is necessary to adjust the final position, use a small brush that has been dipped in water.

Use a damp cloth to soak up excess water.

The use of a decal setting agent such as Solvaset is recommended to assist the decals in snuggling down into the grooves in the body side.

A clear flat finish such as Testor's Dulcote applied to the entire model will seal the decals and hide the film.

NOTE: Decals adhere best to a gloss surface.

Pre 1972 Style Code & Number 5"

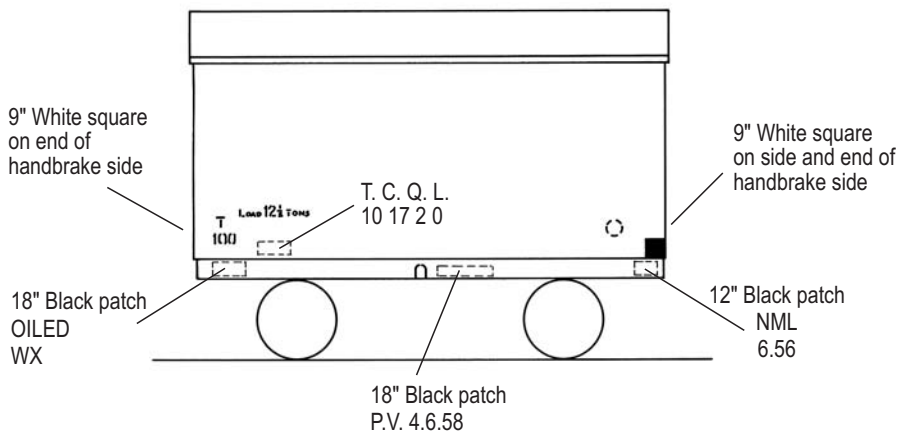

Post 1972 Style Code & Number 7"

